



***THE WHITING***

*The spotlight's on you!™*



## James H. Whiting Auditorium (dba The Whiting)

1241 E. Kearsley Street  
Flint, MI 48503  
Time Zone: EST

Main Phone Number: (810) 237-7337  
Ticket Center: (810) 237-7333  
Fax: (810) 237-7335  
Website: <http://www.TheWhiting.com>  
General E-Mail: [info@TheWhiting.com](mailto:info@TheWhiting.com)



## Contact Information

---

1241 E. Kearsley Street Flint, MI 48503 Time Zone: EST

Main Phone Number: (810) 237-7337  
Ticket Center: (810) 237-7333  
Fax: (810) 237-7335  
Website: <http://www.TheWhiting.com>  
General E-Mail: [info@TheWhiting.com](mailto:info@TheWhiting.com)

Carpenter/Steward: Dennis Hintz  
(810) 237-7376  
[DHintz@TheWhiting.com](mailto:DHintz@TheWhiting.com)

Electrician: Ken Harris  
(810) 237-7338  
[KHarris@TheWhiting.com](mailto:KHarris@TheWhiting.com)

Ticket Center: (810) 237-7333  
Labor Day – June 30 Summer Hours  
Hours: Mon – 11pm–6pm Mon – Fri 11pm–6pm  
Fri  
Sat 10am–3pm Sat Closed  
Sun Closed Sun Closed

\*Open 2 hours before curtain and 30 minutes after curtain on days with performances.

Ticket Center/Guest Services Manager: Adam DeVries  
(810) 237-7372  
[ADeVries@TheWhiting.com](mailto:ADeVries@TheWhiting.com)

Advertising & Promotions Manager: Wendi Fournier  
(810) 237-8689  
[WFournier@TheWhiting.com](mailto:WFournier@TheWhiting.com)

Front of House Manager: Michelle Pratt  
(810) 237-7375  
[MP Pratt@TheWhiting.com](mailto:MP Pratt@TheWhiting.com)

Education Coordinator: Christi Lackey  
(810) 237-7342  
[CLackey@TheWhiting.com](mailto:CLackey@TheWhiting.com)

Rental and Artist Services: Penny Patterson  
(810) 237-7350  
[PPatterson@TheWhiting.com](mailto:PPatterson@TheWhiting.com)

Information System Manager: Todd Tiffany  
(810) 237-5156  
[TTiffany@TheWhiting.com](mailto:TTiffany@TheWhiting.com)

IATSE Contact: Local 201 Flint Stage Employees  
Business Contact: William Hinderer  
(810) 820-6678

## **Line Set Schedule:** See page 7

(Arbor cap. Is 700lbs piece weight)

Pipe Length is 63 Grid Height 70'

Pipes must come in to deck to load and travel to 68'

Proscenium: 30'H X 55'W plaster to plaster

Stage Depth: 35'6" plaster line to back wall

Fly System: compound

Fly Floor: S.L. – Elevated @ 21' / Clearance to 17'

Thrust: Hardwood P.L., to D.S. Edge 5'6" @ Center Line 3'10" Stage R&L

All band shell ceiling pieces and House Picture Sheet are permanent

Stage Dimensions: See drawing below

Proscenium:

Width: 55'

Height: 30'

See Diagram for additional information

## **Pit Lift:**

Auditorium has one hydraulic lift. Lift may be used for orchestra level seating. Lift may be used as a stage extension or lowered to create an orchestra pit. Use of the lift as an orchestra pit or stage extension creates a loss of 150 seats.

## **Orchestra Shell:**

Orchestra Shell consists of 13 pieces, 32'H X 8'W stored stage right/permanent

2 ceiling pieces – see line set schedule

Shell may be configured in four arrangements. (See illustrations below)

1. Band Shell regular setup
2. Wide square setup
3. Band Shell half stage setup
4. Played to CYC, no back wall

## **Soft Goods Inventory:**

Front curtain: guillotine with matched side tabs

50% fullness, burgundy

5 black borders 10'H X 60'W, 50% fullness

4 black travelers full stage 30'H X 60'W, 50% fullness

2 sets of black legs 30'H X 20'W, flat-no fullness

1 blackout drop/2 pieces 30'H X 32'W

1 black scrim 55'W X 30'H

1 white scrim 55'W X 30'H

1 off-white CYC/bounce 60'W X 30'H

## **Loading Dock:**

Dock height is 42" and is level with the stage floor. There is enough space for 2 trucks/trailers at the dock. They can remain parked at the dock for the duration of the stay. 53' trailers must drop 1<sup>st</sup> trailer then back in 2<sup>nd</sup> rig.

Loading door dimensions are 14'H X 10'W

## **Support Areas:**

Dressing Rooms: see diagram below for layout

All dressing rooms are at the stage (first floor) level. Each room is equipped with makeup counters, mirrors with lights, sink, toilets and showers.

Suite dressing rooms are completely barrier free, including all toilet/shower facilities.

Quantity Capacity Description:

2 1-4 person private rooms

2 4-8 person standard rooms

2 20 person chorus rooms

Each standard dressing room is wired for telephone (local only), fax, and may double as a production office. Unlimited broadband internet access is available in each dressing room; wired and wireless access available.

Green Room:

A fully equipped green room is located directly off the loading dock. Refrigerator, microwave, dishwasher, and coffee makers are available. The room seats 10-25. There is telephone/fax/internet service and may double as a production office. It is also mirrored and can be converted to additional dressing room space as required.

All dressing rooms and green room have phone, fax, and computer hookups. Wired and wireless (802.11a/b/g) internet access available.

## **Laundry:**

2 - Heavy duty washers (additional hook-ups on loading dock)

2 - Heavy duty dryers (additional hook-ups on loading dock)

2 - Steam irons and ironing boards

3 - Jiffy steamers with wand

1 - Deep tub sink

8 - 6' long rolling costume racks

The backstage area includes a handicapped accessible entrance and barrier free restroom in the loading dock area.

## **Electrical:**

### **Company Switches:**

- #1: 120/208 VAC, 3 phase, 5 wire, 400A/LEG  
Double Neutral
  - #2: 120/208 VAC, 3 phase, 5 wire, 200A/LEG
  - #3: 120/208 VAC, 3 phase, 5 wire, 400A/LEG  
Double Neutral
  - #4: 120/208 VAC, 3 phase, 5 wire, 100A/LEG
  - #5: 120/208 VAC, 3 phase, 5 wire, 100A/LEG for sound
- Power derived from isolated transformer used for sound power.  
All switches located off stage left.  
Shore power does not exist for buses or trucks.

### **Dimmers:**

- 223 ETC 2.4 dimmer available (dimmer/circuit)
- 152 on stage 71 in house (box booms & coves & balcony rails)

### **Lighting control:**

- ETC insight 3x located in an enclosed booth at rear of main floor.
- ETC snapshot controllers located in booth and backstage left

### **Lighting instruments:**

- (36) P64 1000w
- (36) S4P 575W
- (12) Parnel
- (100) S4 Leko (36 degree, 26 degree, 19 degree, and 50 degree available)
- (5) 3 cell far CYC lights 1000W

### **Front of House Hang:**

- (16) Source 4 5° (Far/Cove)
- (21) 10° 575W (Near/Cove)

### **Follow Spots:**

- (2) Xenon Super Trooper II 2000W

### **Circuits on Stage:**

- (20) Floor pockets SL/SR/US
- (121) Overhead circuits (20 on #1 electrical raceway)
- (6) DSL or DSR wall (mirrored)
- (23) In four drops SR
- (14) In four drops SL

### **Circuits Front of House**

- (20) 5 each box boom – 40' average throw (acute)
- (27) Near cove – 80' throw (steep)
- (12) Far cove – 150' throw (45°)
- (8) Rear Balcony Rail – 100' throw (flat)
- (4) Mirrored Side Balcony Rail – 60' throw (flat)

### **Miscellaneous:**

- (4) 14' rolling booms
- (4) 2' Boom Bases 1½" Thread
- Assorted length 1½" Pipe (21' - 4')
- Assorted pipe clamps and small pipes

Audio:

Audio/communication

House sound console is located at the rear of the orchestra level

Road sound system will be placed in the barrier free box in front of house sound board requiring the elimination of 12 seats

House mixing console – DDA Model CS8

32 input channels

4 output channels

4 monitor channels

4 DBX equalizer/limiters

Main cluster JBL/Side Stacks available

8 JBL Monitor Wedges/MR Series

10 SM58 microphones

8 JBL Monitor Wedges – MR Series

4 Beta 58A, 4 Beta 87A, 4 Beta 57A

4 Crown PCC 160

4 Samson wireless handheld w/58 heads or 4 lav. units

Assorted microphone stands

2 channel clear-com headset w/11 locations

2 stage right/one up, one down stage

3 stage left/one up, two down stage

2 follow spot locations

1 fly

1 backstage office

Sound Booth

1 light booth

4 wireless headsets

Monitors in dressing rooms for pages and announcements and program feed

**Other equipment available:**

100 - Black orchestra chairs

70 - Music stands

50 – Music stand lights

6 – 3 step choral risers

7 – 4' X 8' risers 8" high

8 – 4' X 8' risers 16" high

11 – 4' X 8' risers 24" high

2 – Conductor podiums

2 – Full height lecterns

1 – Genie 360' personnel lift

Assorted 4-wheel hand trucks & 2 wheel carts

1 – 9' Steinway concert grand piano

1 – Full stage orchestra shell w/ceilings and lights (must be set in place)

Marley dance floor (black) Harlequin cascade tap responsive

1 – Standard Marley surface

**LINESET SCHEDULE**

LINE	DIST	Name	Comments
1	0'-6"		Works From Deck
2	1'-6"	Front Curtain #1 Winch Pipe w/side masking tabs	Guillotine (Burgundy) Works from deck (Burgundy)
3	2'-6"		
4	3'-0"		
5	4'-0"	#1 Electric	W / Raceway
6	5'-0"	#1 Border Light	W / Raceway
7	5'-6"		
8	6'-0"	Picture Sheet	PERMANENT
9	6'-6"		
10	7'-0"		
11	7'-6"		
12	8'-0"	# 1 Border	
13	8'-6"	# 1 Traveler	
14	9'-0"		
15	9'-6"		
16	10'-0"		
17	10'-6"		
18	11'-0"	# 2 Electric	
19	11'-6"		
		3 foot Dead Spot # 2 Winch Pipe # 3 Winch Pipe	Band Shell Ceiling Piece / PERMANENT
20	14'-6"		
21	15'-6"	# 2 Border	
22	16'-0"	# 2 Traveler	
23	16'-6"		
24	17'-0"		
25	17'-6"		
26	18'-0"		
27	18'-6"		
28	19'-0"	# 3 Electric	
29	20'-0"		
30	20'-6"		
31	21'-0"		
32	21'-6"		
33	22'-0"		
34	22'-6"		
35	23'-0"	# 3 Border	
36	23'-6"	# 3 Traveler 2½ Foot Dead Spot # 4 Winch Pipe	Band Shell Ceiling Piece / PERMANENT
37	26'-0"		
38	26'-6"		
39	27'-0"		
40	28'-0"		
41	28'-6"	# 4 Electric / CYC Lights	
42	29'-0"		
43	29'-6"		
44	30'-0"		
45	30'-6"		
46	31'-0"		
47	31'-6"		
48	32'-0"	# 4 Border	
49	32'-6"	# 4 Traveler	
50	33'-0"		
51	33'-6"		
52	34'-6"		
53	35'-0"	Cyclorama (off-white)	
54	35'-6"	Blackout Curtain	

**\* HOUSE HANG SUBJECT TO CHANGE \***

5 borders, Black 10'H X 60'W / 50% fullness / 4 travelers, Black 30'H X 60'W / 50% fullness

2 Pair Black Legs 20'W X 30'H / Flat / Blackout Curtain 2 pieces, 30'H X 32'W Flat

2 Scrim, One Black, One White, 30'H X 55'W / One Cyclorama 30'H X 60'W off-white

# Band Shell Layout Diagrams

## Diagram #1 Band Shell Regular Set Up

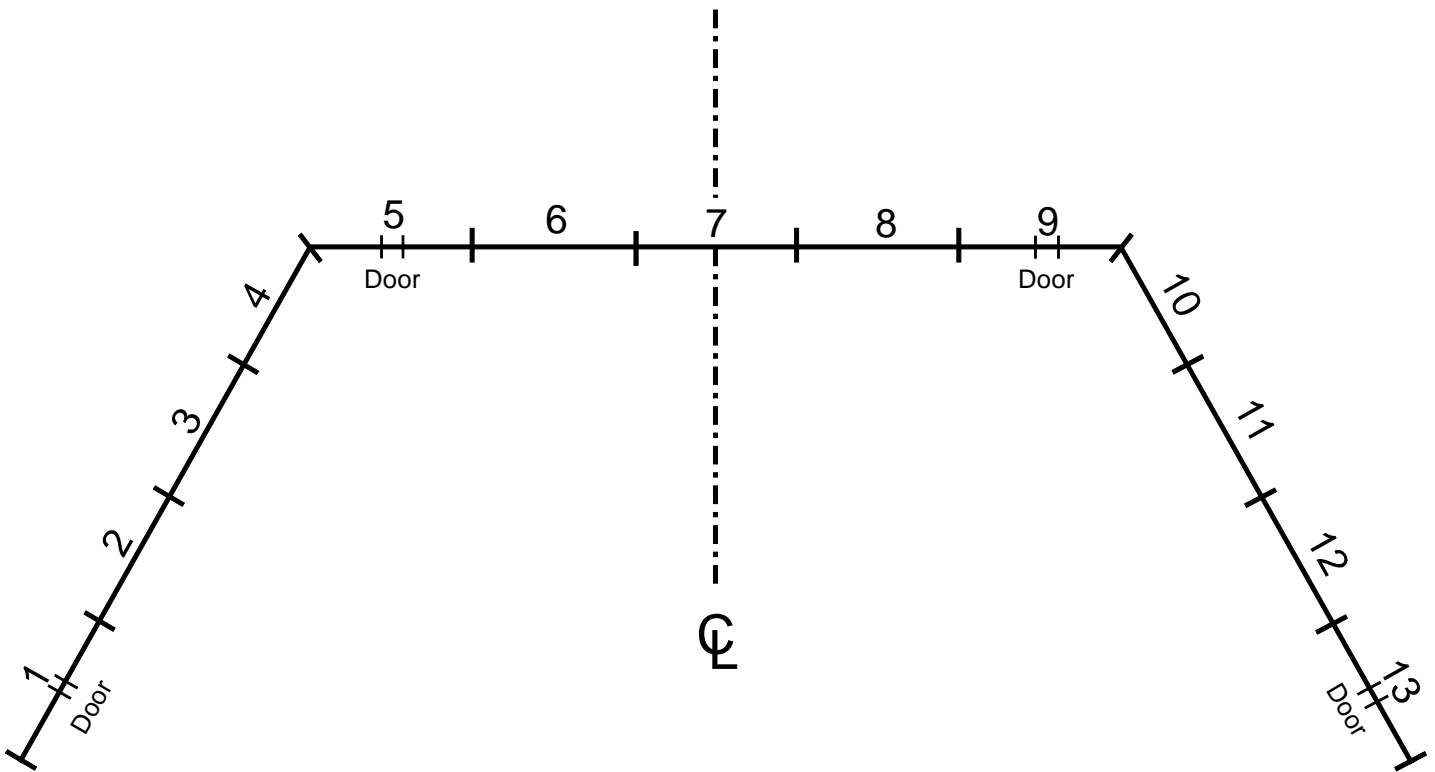



# Diagram #3

## Band Shell Wide Square Set Up

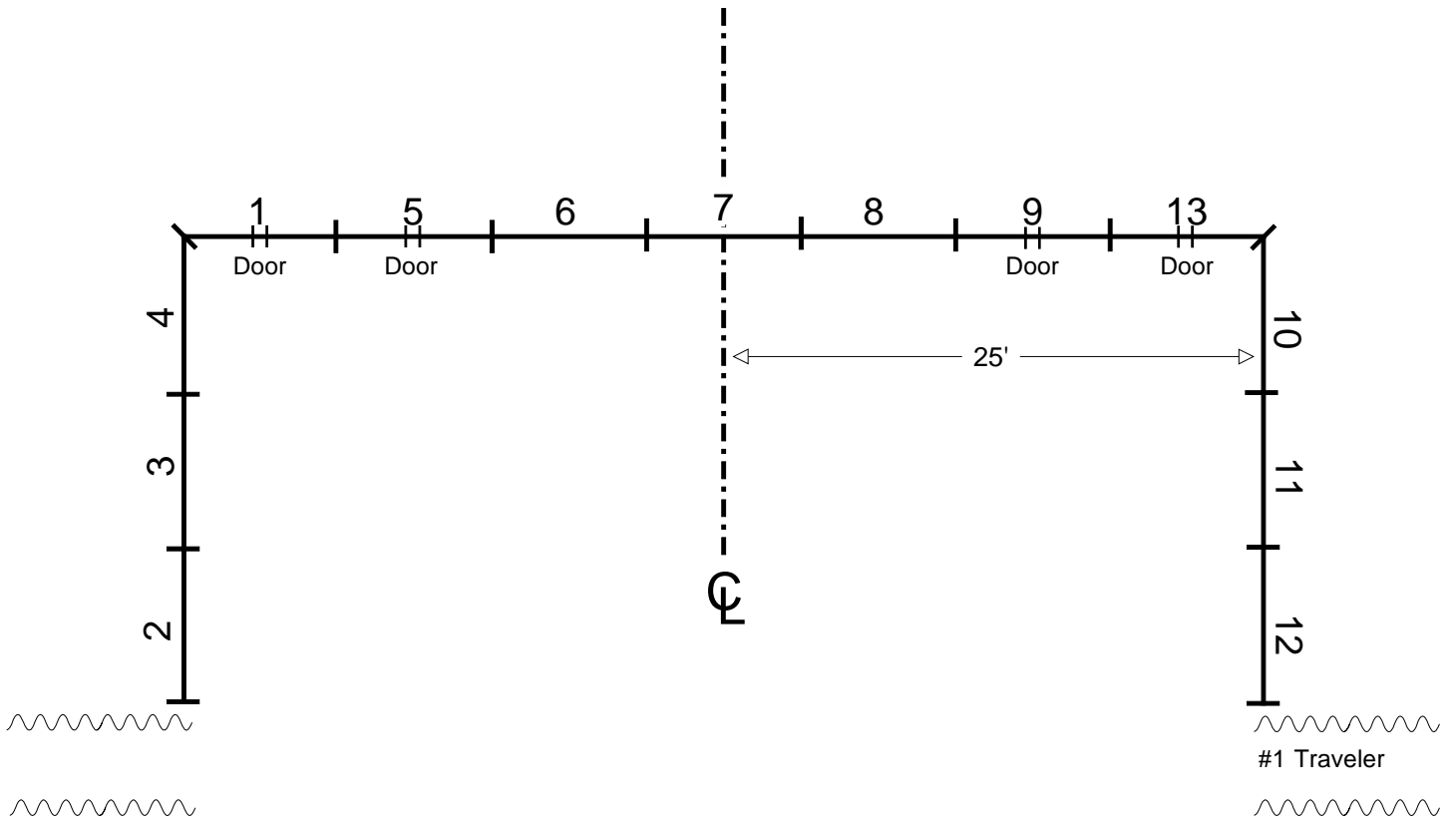

# Diagram #4

## Band Shell Played to CYC

### No Back Wall

